

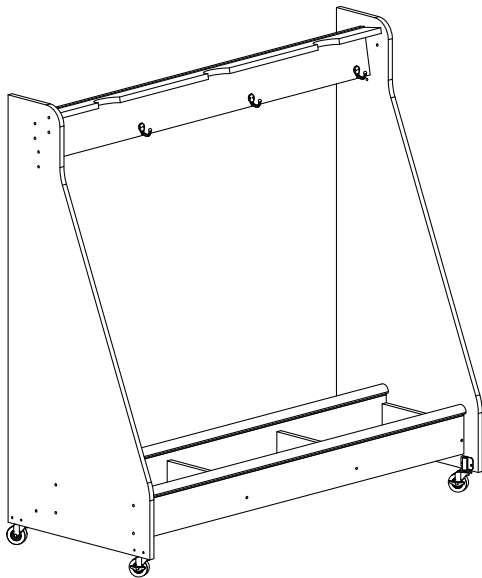

Your Performance Partner

Assembly Instructions Cello/Bass Storage Rack



3-Unit Bass Rack

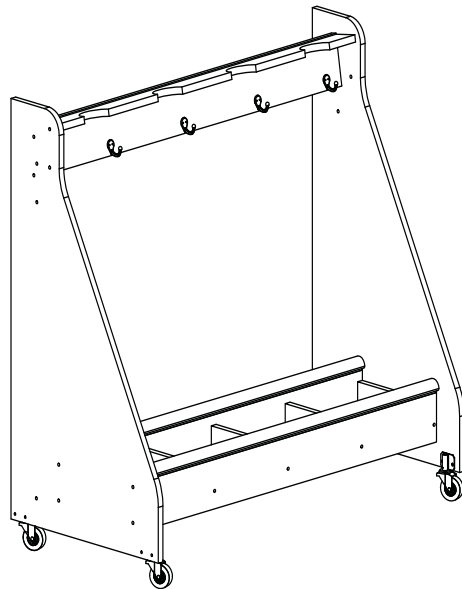

4-Unit Cello Rack

CONTENTS

Safety Precautions	2
Warranty	2
Important User Information	3
General	3
Manufacturer	3
Intended Use	3
Before You Begin	4
Required Tools	4
Fastener List	4
Parts List	5
Assembly	6-10
Operation	11
Replacement Parts	12

Please read and understand these Assembly Instructions before working with or using the Cello/Bass Storage Rack.

If you need additional information about the Cello/Bass Storage Rack, contact Wenger Corporation using the information below.

SAFETY PRECAUTIONS

Throughout this manual you will find cautions and warnings which are defined as follows.

- **WARNING** means that failure to follow the instruction may result in serious injury or death.
- **CAUTION** means that failure to follow the instruction may result in serious injury or damage to property.

Read all of these safety instructions before setting up the Cello/Bass Storage Rack components.

<p>! CAUTION</p> <p><i>Make sure that anyone working on the Cello/Bass Storage Rack has read and understands this manual.</i></p>	<p>! CAUTION</p> <p><i>It is unsafe for only one person to assemble or move the Cello/Bass Storage Rack.</i></p>	<p>! CAUTION</p> <p><i>Eye protection is required when assembling the Cello/Bass Storage Rack.</i></p>
--	---	---

WARRANTY

The Cello/Bass Storage Rack is guaranteed free of defects in materials and workmanship for five full years.

Our guarantee assures you of either a full refund or repair or replacement of the defective materials or workmanship without charge, at the discretion of our Customer Service Department. Just call a Customer Service Representative at 1-800-887-7145 and state the reason you are dissatisfied. If a product return is necessary, your representative will issue a return authorization. This is your sole remedy for breach of this warranty.

Should you have a question or problem with any Wenger product, don't hesitate to call, even if the product is past warranty. It's important to us that all our customers be satisfied.

This is the sole warranty made by Wenger. Wenger disclaims all other warranties, including the warranties of merchantability and fitness for a particular purpose, as well as all liability for incidental, consequential, special, and indirect damage. Wenger liability for direct damages shall be limited to the amount you paid for the product involved. Wenger reserves the right to make product changes without obligation to incorporate such changes into products previously sold.

Some states do not allow the exclusion or limitation of damages or warranties, so the above may not apply to you. This warranty gives you specific legal rights. You may also have other rights which vary from state to state.

IMPORTANT USER INFORMATION

GENERAL

Copyright© 2009 by Wenger Corporation

All rights reserved. No part of the contents of this manual may be reproduced, copied, or transmitted in any form or by any means including graphic, electronic, or mechanical methods or photocopying, recording, or information storage and retrieval systems without the written permission of the publisher, unless it is for the purchaser's personal use.

Printed and bound in China.

The information in this manual is subject to change without notice and does not represent a commitment on the part of Wenger Corporation. Wenger Corporation does not assume any responsibility for any errors that may appear in this manual.

In no event will Wenger Corporation be liable for technical or editorial omissions made herein, nor for direct, indirect, special, incidental, or consequential damages resulting from the use or defect of this manual.

The information in this document is not intended to cover all possible conditions and situations that might occur. The end user must exercise caution and common sense when assembling or installing Wenger Corporation products. If any questions or problems arise, call Wenger Corporation at 1-800-733-0393.

MANUFACTURER

The Cello/Bass Storage Racks are manufactured for:

Wenger Corporation
555 Park Drive
Owatonna, MN 55060
1-507-455-4100 • 1-800-733-0393 www.wengercorp.com

INTENDED USE

- This product is intended for indoor use in normal ambient temperature and humidity conditions — it must not be exposed to prolonged outside weather conditions.
- This product is intended to be assembled only as described in these instructions.

BEFORE YOU BEGIN

- Read the complete assembly procedure before you begin.
- Open both large cartons, and compare the parts to the “Replacement Parts List” listed below.
- Fasteners and loose parts are packed in the Hardware Pack.

REQUIRED TOOLS

The following tools must be available to assemble the Cello/Bass Storage Rack:

- Plastic Mallet
- Phillips-Head Screwdriver
- Variable Speed Drill (to drive hex socket screws)
- $\frac{5}{32}$ " Hex Insert Bit (supplied).

FASTENER PARTS LIST

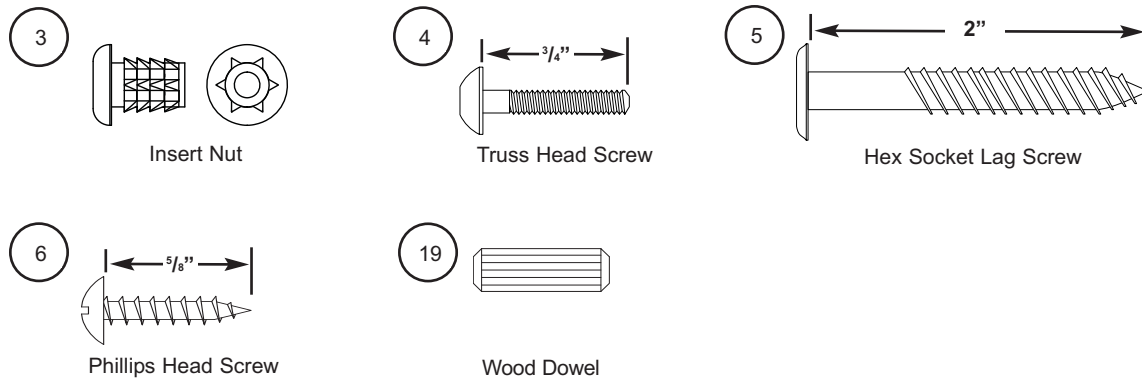

- Some quantities vary depending on the model.
- Extra hardware can be discarded.

PARTS LIST

- Parts appear in 3D to provide visual of pre-drilled hole placement.
- Pre-drilled holes vary by size and model of unit.
- Some quantities vary depending on the model.
- Extra hardware can be discarded.

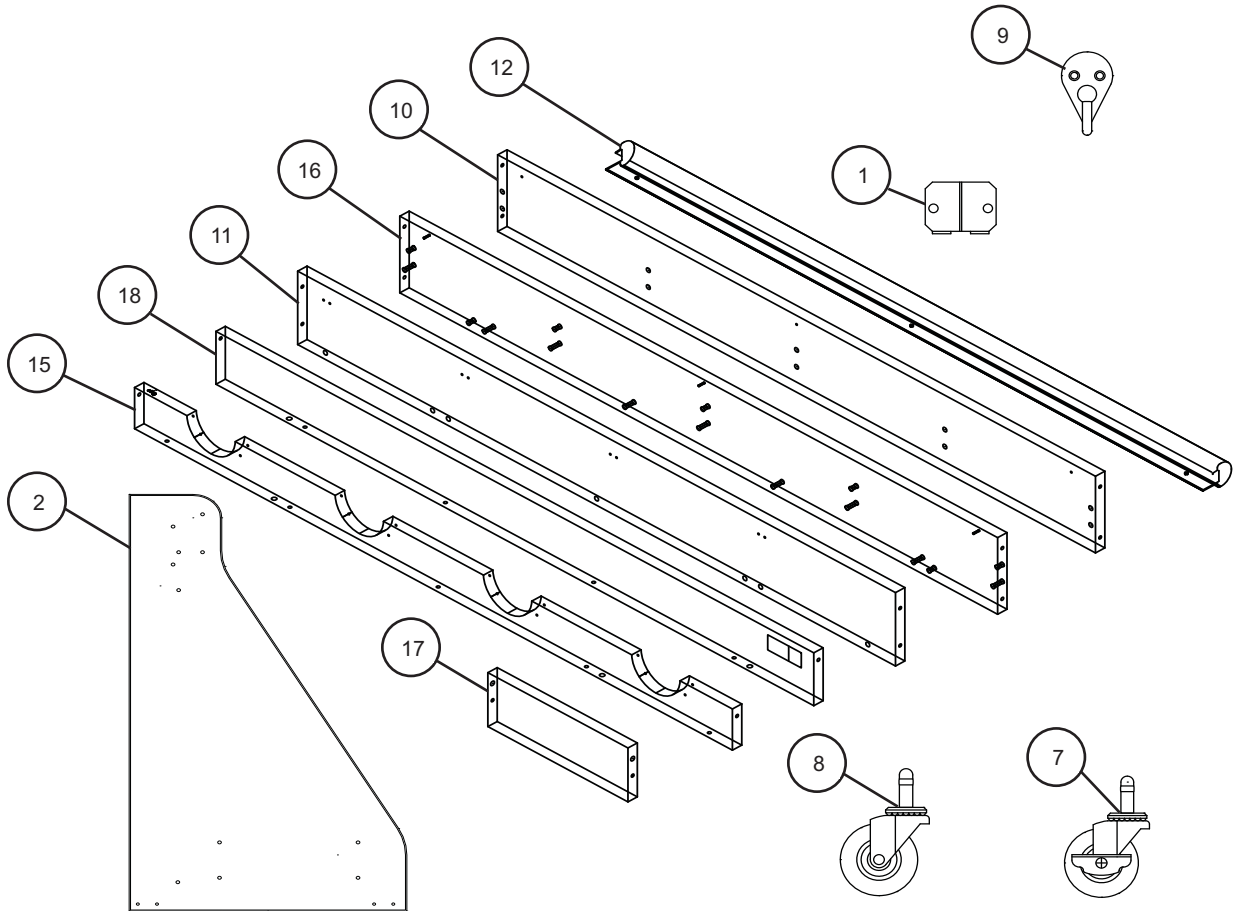

<u>Item</u>	<u>Qty</u>	<u>Description</u>	<u>Item</u>	<u>Qty</u>	<u>Description</u>
1	4	Bracket, caster	10	1	Panel, base, front
2	2	Panel, end, right and left	11	1	Panel, top, cross support
3	8	Nut, insert	12	2	Rails, padded
4	8	Screw, truss-head, 3/4"	15	1	Panel, top, neck support
5	31-41	Screw, Lag, hex socket, 2"	16	1	Panel, base, rear
6	18-30	Screw, small phillips head, 5/8"	17	4-7	Panel, divider
7	2	Caster, locking	18	1	Panel, base, lower support
8	2	Caster, non-locking	19	14-24	Dowel, wood
9	3-6	Hook, brass, with screws			

ASSEMBLY

1. Pound in Insert Nuts (#3). Two on each outside corner of the End Panels (#2). (**Detail A**)

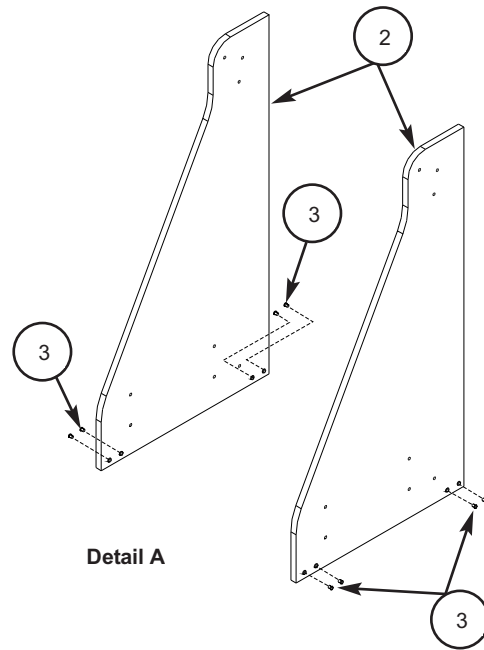

2. Attach Caster Brackets (#1) to the inside corners of the End Panels (#2) with $\frac{3}{4}$ " Truss Head Screws (#4). (**Detail B**)

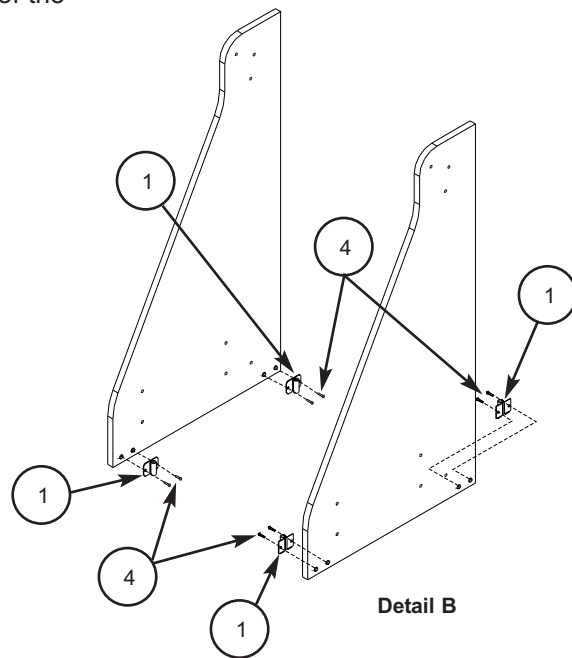

ASSEMBLY (CONTINUED)

3. Assemble Base Support (quantities of Divider Panels, Wood Dowels and Hex Head Lag Screws will vary depending on model).

- Insert one wood Dowel (#19) into each Divider Panel (#17). **(Detail C)**
- Secure the Divider Panels with Dowels to the Rear Base Panel (#16) using 2" Hex Socket Lag Screws (#5).

Important Note: If you experience problems with alignment during assembly, dowels may be removed and not used.

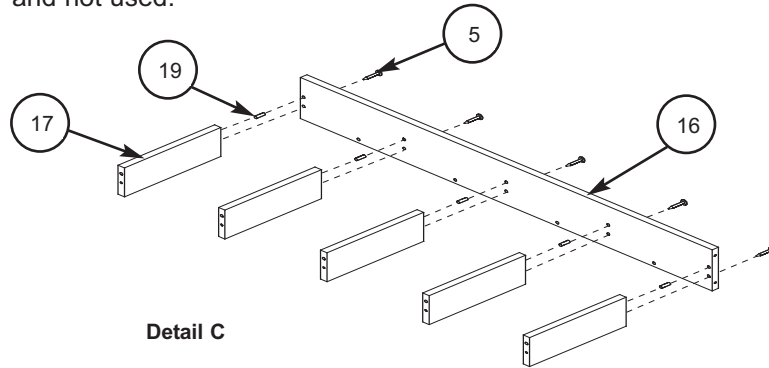

- Insert two Wood Dowels (#19) into the Lower Support Base Panel (#18). **(Detail D)**
- Secure Lower Support Base Panel with Dowels to Rear Base Panel (#16) using 2" Hex Socket Lag Screw (#5).

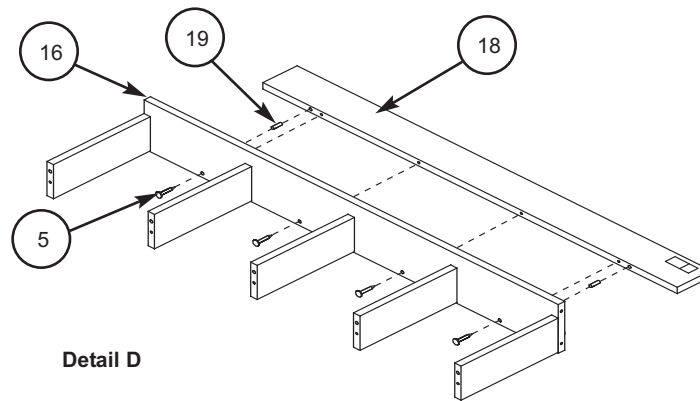

- Insert one Wood Dowel (#19) into each Divider Panel (#17). **(Detail E)**
- Secure Divider Panels with Dowels to the Front

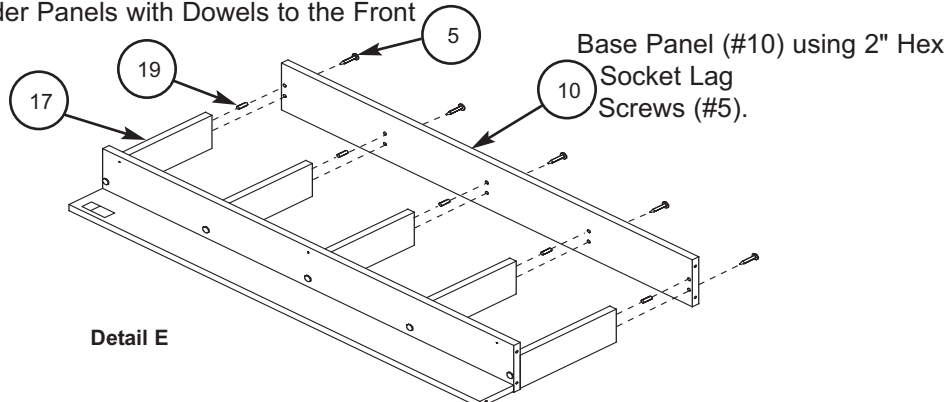

ASSEMBLY (CONTINUED)

4. Attach one Padded Rail (#12) to the Front Base Panel (#10) using three $\frac{5}{8}$ " Phillips Head Screws (#6) (**Detail F**).
5. Repeat step 4 on the Rear Base Panel (#16).

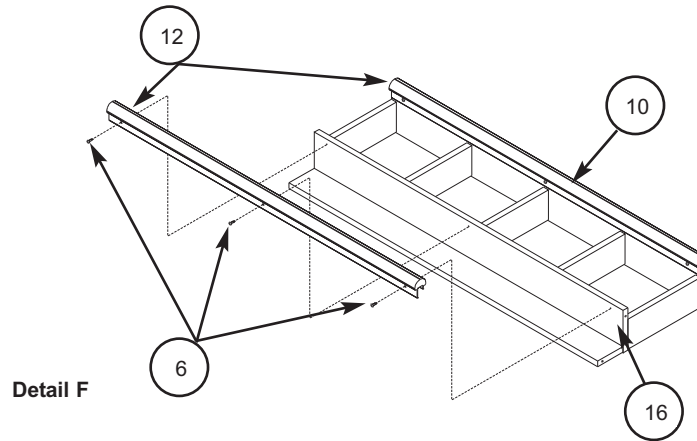

6. Attach the Base Support Assembly to the End Panels (#2) using five Hex Socket Lag Screws (#5) per side. (**Detail G**)

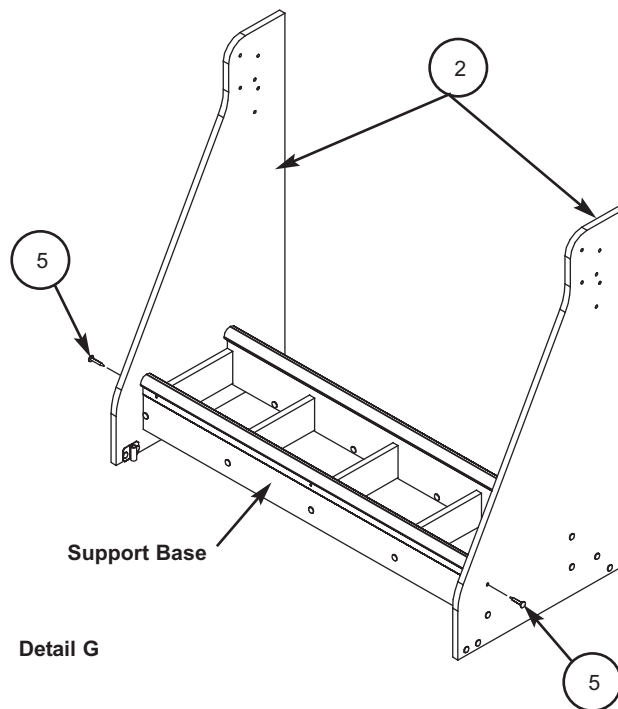

ASSEMBLY (CONTINUED)

7. Assemble Top Cross support (quantities of Wood Dowels (#19) and Hex Head Lag Screws (#5) will vary depending on model) .
 - a. Insert Wood Dowels (#19) into the Neck Support Top Panel. **(Detail H)**
 - b. Secure the Neck Support Top Panel (#15) with Dowers to the Cross Support Top Panel (#11) using 2" Hex Socket Lag Screws (#5).

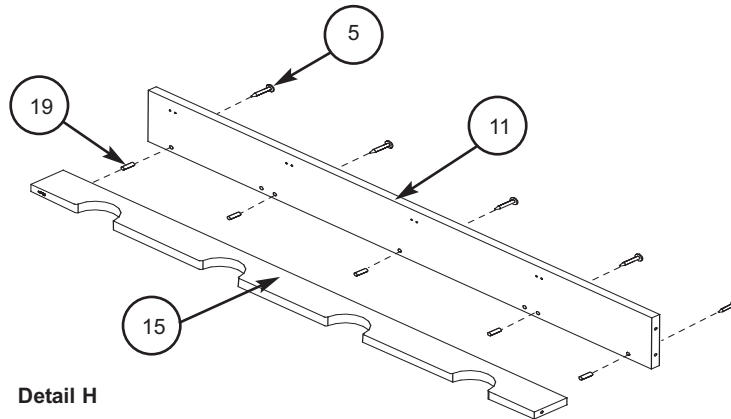

- c. Attach the Brass Hooks (#9) with the supplied Brass Screws to the top Cross Support Panel (#11). Note: Quantity will vary depending on model. **(Detail I)**

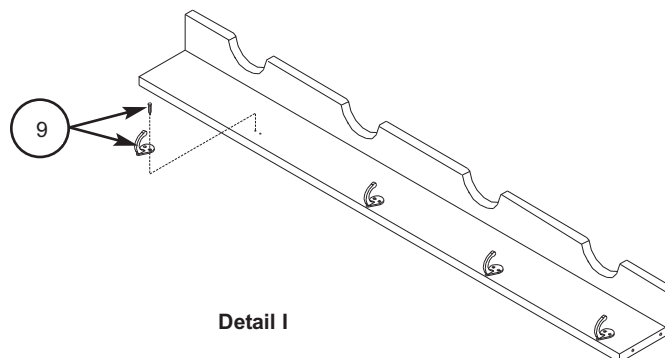

ASSEMBLY (CONTINUED)

- Attach the Top Cross Support Assembly to the End Panels (#2) using three Hex Head Lag Screws (#5) per side. **(Detail J)**

NOTE: For 1/2 size Cellos and Basses, use the lower set of holes labeled "B" for attaching The top Cross Support Assembly. **(Detail K)**

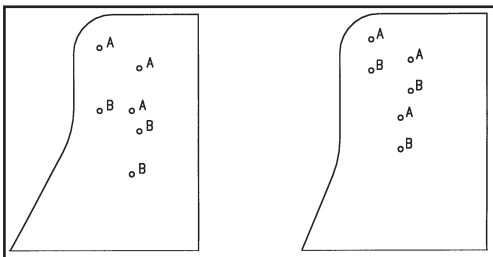

Detail K

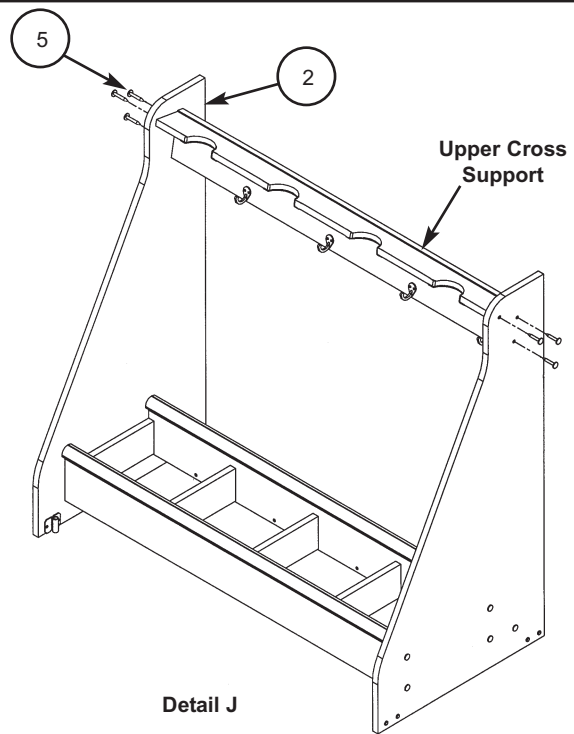

Detail J

- Snap the two Locking Casters (#7) into the front Caster Brackets (#1) and the two Non-locking Casters (#8) into the back Caster Brackets (#1). **(Detail L)**

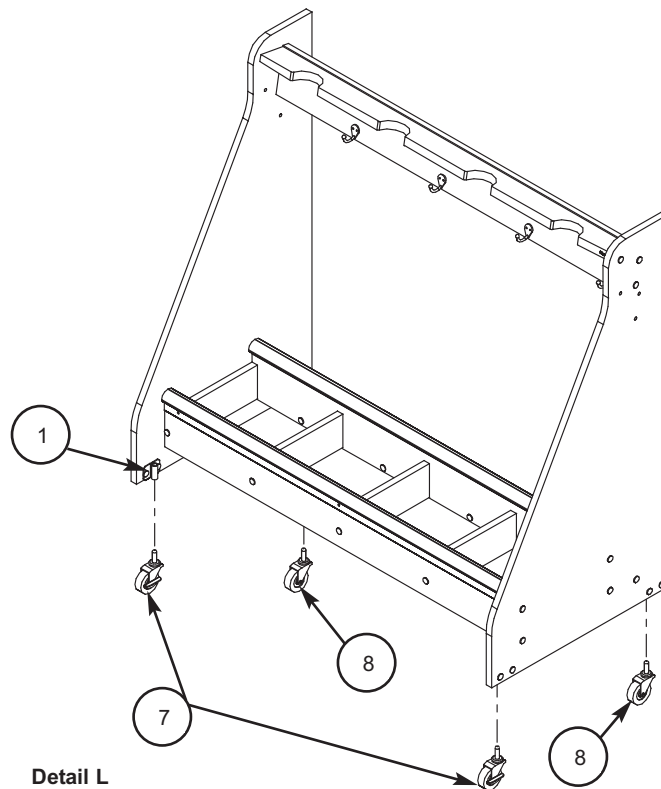

Detail L

OPERATION

Before placing instruments on the mobile rack, be sure the casters are in the locked position. Unlock the casters to move the rack. Two people are recommended to move the rack. Move the rack slowly and carefully making sure the instruments stay in place during transport.

REPLACEMENT PARTS (CONTINUED)

Item	Qty	Description	Item	Qty	Description
1	4	Bracket, caster	10	1	Panel, base, front
2	2	Panel, end, right and left	11	1	Panel, top, cross support
3	8	Nut, insert	12	2	Rails, padded
4	8	Screw, truss-head, 3/4"	15	1	Panel, top, neck support
5	31-41	Screw, Lag, hex socket, 2"	16	1	Panel, base, rear
6	18-30	Screw, small phillips head, 5/8"	17	4-7	Panel, divider
7	2	Caster, locking	18	1	Panel, base, lower support
8	2	Caster, non-locking	19	14-24	Dowel, wood
9	3-6	Hook, brass, with screws			

